

## WARRANTY

Warranty period of this product is 1 year from the date of purchasing.

Write down the date and place of purchasing and present it to the maintenance service provider so that you may get free maintenance service during the period.

|                     |               |                    |  |
|---------------------|---------------|--------------------|--|
| Customer            |               | Date of Purchasing |  |
| Place of Purchasing | Seller's Name |                    |  |
|                     | Phone Number  |                    |  |
|                     | Address       |                    |  |

Please note that, with the breakdown or malfunction due to the following causes, you will have to pay for the maintenance expenses even during the warranty period:

1. failure to comply with the safety instructions of this manual.
2. careless handling or misuses by the users
3. natural calamities such as fire, flood, earthquake, etc.

White Single Pole (PH-633)



Ivory Shelf Hanger (PH-456)



Adjustable Double Shelf (PH-349)



Curtain Shelf Hanger (PH-532)



Country of Origin: Korea, The Republic of.  
Imported by:  
www.

## Bathroom Shelf

Model No. PH-499



# Safety Instructions

**⚠ Please keep the following instructions to prevent any possible dangers or losses while installing or using the product.**

1. This hanger system is designed to stand and hold out with its poles pressed against the floor and the ceiling. Determine the place to install it where both the floor and the ceiling are robust enough to withstand the load and pressure from the poles.

2. A thicker pole or bar can contain a thinner one within and, if held open end down, let the thinner one slip out and fall down to hurt the feet or damage the floor underneath. So hold it properly when carrying or handling.

3. Before starting assembling, pull out the red check pin first that is placed below the one-touch fastener of the one-touch fastener. See the picture below left.

### Pulling out the check pin

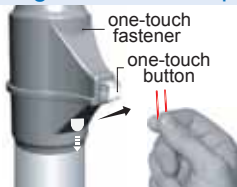

- ▶ Push the pin down while pressing the one-touch button slightly.
- ▶ The check pin is only meant for packaging. Just throw it away.

## Package Contents

- ① upper extension pole (1)
- ② lower pole (1set)

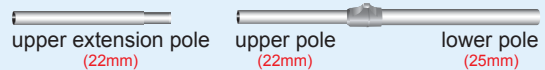

- ③ safety bolt (1) — for one-touch fasteners

- ④ upper pole cap (1)

- ⑤ lower pole cap (1)

- ⑥ shelf (4) — (2X22mm) (2X25mm)

- ⑦ rubber rings (4)

# Assembling the Poles

▼ Insert the parts into each pole in the following numerical order.

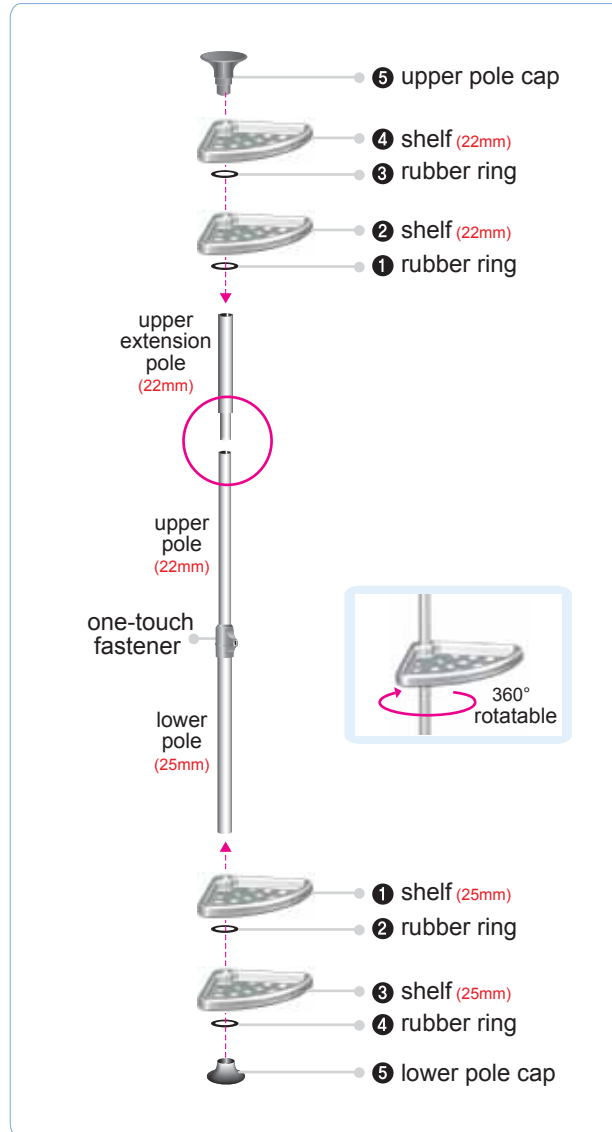

# Putting up the Poles

## Putting up the Poles

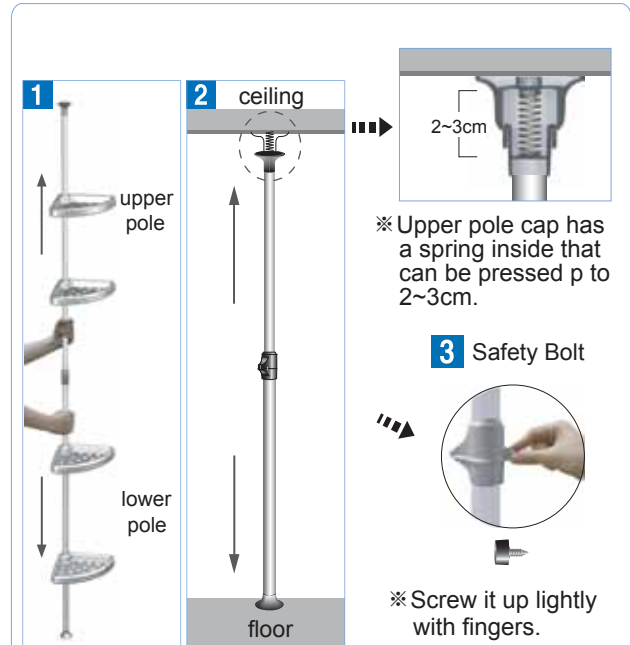

1. Hold the lower pole with one hand and the upper pole with the other.
2. Push up the upper pole toward the ceiling to the extent it presses the spring inside the upper pole cap hard enough.
3. Screw up the safety bolt lightly with fingers.

## Disassembling the Poles



Let loose the safety bolt and, holding the upper pole with one hand, press the one-touch button with the other so that the upper pole may slide down.